

MUST-DO TIPS:

Each time when you connect the hard drive to your iPhone, iPad, Macbook or PC for data transfer or storage, please remember to press the **“ON/OFF Button”** until your devices detect the hard drive, otherwise, the hard drive will not be displayed on your devices.

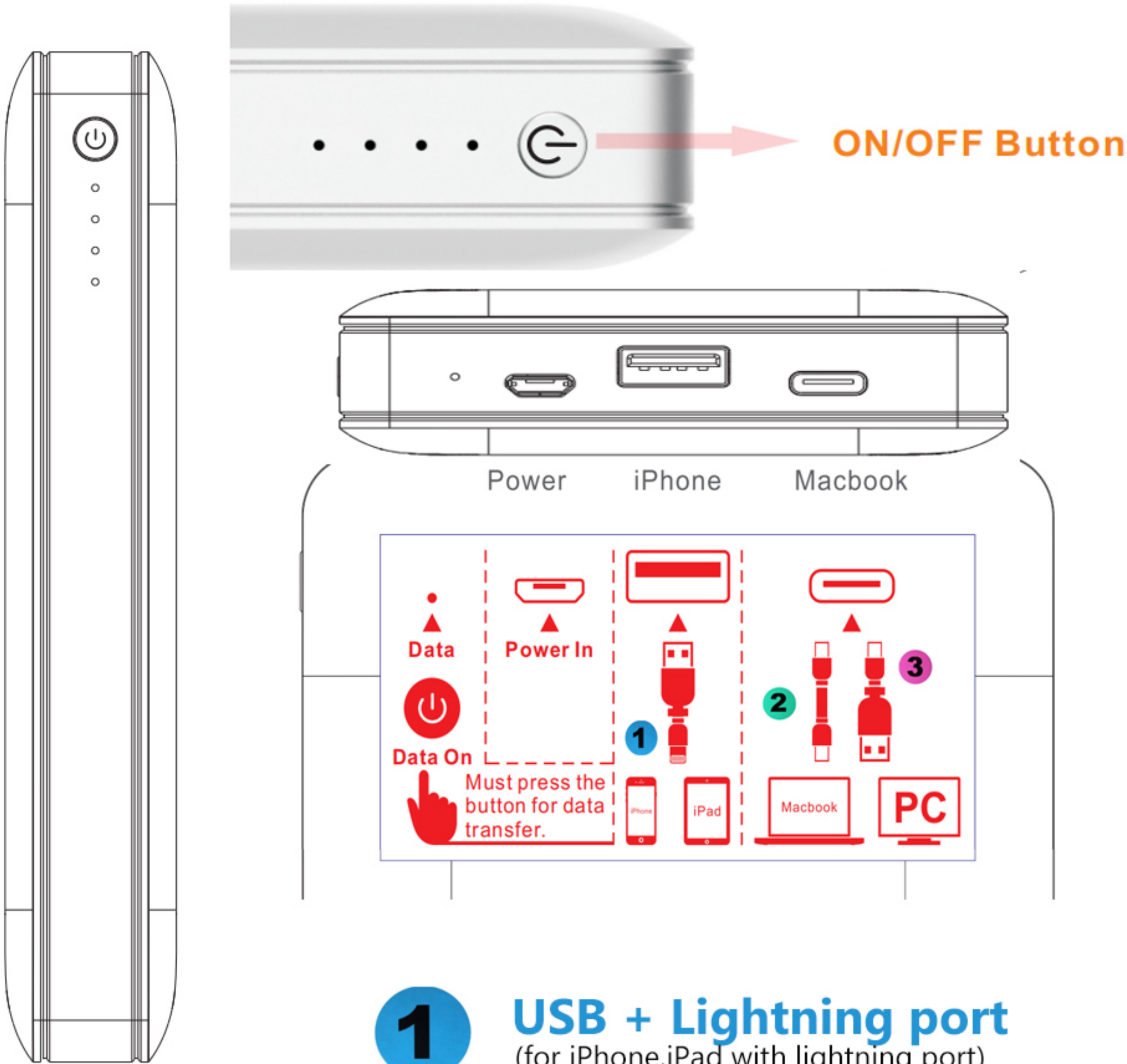

Cable

1 **USB + Lightning port**
(for iPhone, iPad with lightning port)

2 **Type C + Type C port**
(only for **Macbook** with Type C port)

3 **USB + Type C port**
(for PC and New iPad with Type C port)